

TECHNICAL DATA SHEET

modee.

Mineral Wall – Tiles

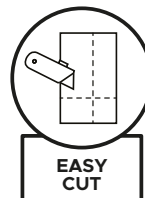
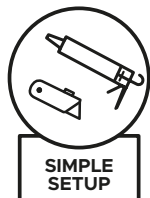
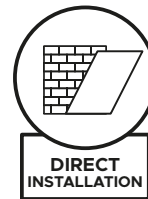
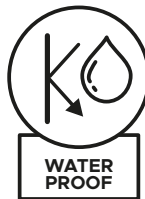
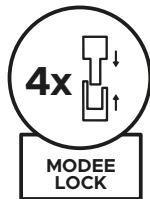

PRODUCT DESCRIPTION

	VALUE	UNIT	TEST METHOD
THICKNESS	4	[mm]	EN ISO 24346
MASS	8544	[g/m ²]	EN ISO 23997
DIMENSIONS	1200 x 600	[mm]	EN ISO 24341

CLASSIFICATION

	VALUE	UNIT	TEST METHOD
PRODUCT SPECIFICATION	-	-	EN ISO 15102
REACTION TO FIRE	B-s2, d0	CLASS	EN 13 501-1
RELEASE OF FORMALDEHYDE	PASSED	-	EN 12149
RELEASE OF HEAVY METALS AND SPECIFIC ELEMENTS	PASSED	-	EN 12149
RELEASE OF VINYL CHLORIDE MONOMER (VCM)	PASSED	-	EN 12149
SOUND ABSORPTION	NPD	-	EN ISO 354
THERMAL RESISTANCE (TR)	0,010	[m ² K/W]	EN 12667

PARAMETERS

	VALUE	UNIT	TEST METHOD
DIMENSIONAL STABILITY	≤ 0,05	[%]	EN ISO 23999
RESIDUAL INDENTATION (RI)	0,01	[mm]	EN ISO 24343
ABRASION RESISTANCE	500	CYCLES	EN ISO 13329
SCRATCH RESISTANCE	24	[N]	EN ISO 1518
THICKNESS SWELLING	0	[%]	EN ISO 24336
MICROSCRATCH RESISTANCE	1,2	[GU]	EN ISO 16094
WATERPROOF	PASSED	[mm]	EN ISO 13553
RESISTANCE TO STAINS AND CHEMICALS:	INDEX 0	-	EN ISO 26987
COFFEE			
ACETONE			
HYDROGEN PEROXIDE, 30%			
SHOE POLISH			
CHLORINE-BASED TOILET CLEANER			
MILDEW REMOVER			
ANTIFUNGAL AGENT			
KITCHEN CLEANER			
SHOWER CLEANER			
DISHWASHING LIQUID			
SOAP			
DESCALER			

ENVIRONMENTAL

	VALUE	UNIT	TEST METHOD
POSSIBILITY OF RECYCLING	100	[%]	-

PARAMETERS

	PACKAGING UNIT	PALLET
FORM	4 PANELS - 2,880 m ²	32 BOXES - 92 160 m ²
WEIGHT	28,04 kg	950 kg
SIZES	1211 x 611 x 20 mm	1250 x 650 x 800 mm